

**Attention:**  
 This drawing is provided as a sample of a Greene County Survey Record. Actual survey will need to meet the "Requirements for Plats of Survey" as shown in the "Requirements for Instruments of Conveyance in Greene County, Ohio"

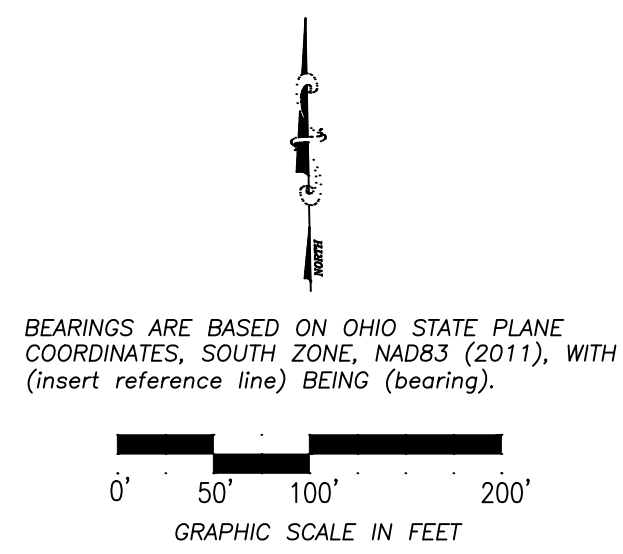

SAMPLE

**MONUMENT LEGEND :**

- I.P.S. IRON PIN SET W/ID CAP (CAPPED "(name) (ps no.)")
- I.P.F. IRON PIN FOUND (SIZE NOTED)
- ⊙ I.P.F. IRON PIN FOUND W/ID CAP (SIZE NOTED)
- ⊙ P.F. IRON PIPE FOUND (SIZE NOTED)
- M.N.S. MAG NAIL SET
- M.N.F. MAG NAIL FOUND
- ⚡ RAILROAD SPIKE SET
- ⊗ RAILROAD SPIKE FOUND
- × CROSS CUT SET
- × CROSS CUT FOUND
- ☐ MONUMENT BOX FOUND



**REFERENCES**

- RECORD PLANS
- RIGHT OF WAY PLANS
- SURVEY RECORDS

**SURVEY NOTES**

1. OCCUPATION IN GENERAL FITS SURVEY, UNLESS OTHERWISE NOTED.
2. MONUMENTATION IS IN GOOD CONDITION UNLESS OTHERWISE NOTED.

**APPROVED GREENE COUNTY ENGINEER**

By \_\_\_\_\_ Date \_\_\_\_\_

APPROVED BY: \_\_\_\_\_

ZONING \_\_\_\_\_ DATE \_\_\_\_\_

RPCC, CITY, OR VILLAGE \_\_\_\_\_ DATE \_\_\_\_\_

**CERTIFICATION**

I HEREBY CERTIFY THAT THIS PLAT OF SURVEY IS PREPARED IN ACCORDANCE WITH OHIO ADMINISTRATIVE CODE 4733-37, STANDARDS FOR BOUNDARY SURVEYS AND PERFORMED UNDER MY DIRECT SUPERVISION IN (month), 2022 AND THAT DIMENSIONS ARE CORRECT AND MONUMENTS HAVE BEEN FOUND OR SET AS INDICATED.

JOHN Q. SURVEYOR, PROFESSIONAL SURVEYOR No. XXXX  
 DATE OF SURVEY : 00/00/0000

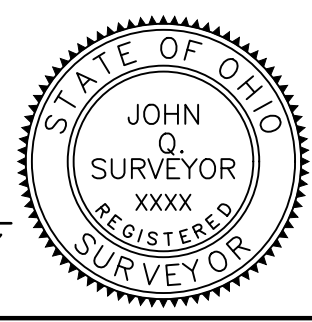

GRANTOR \_\_\_\_\_

GRANTEE \_\_\_\_\_

LOCATION \_\_\_\_\_

Section \_\_\_\_\_, Town \_\_\_\_\_, Range \_\_\_\_\_

or Survey No. \_\_\_\_\_

GREENE COUNTY, OHIO

DATE \_\_\_\_\_ SCALE: 1" = xxx'

SAMPLE